

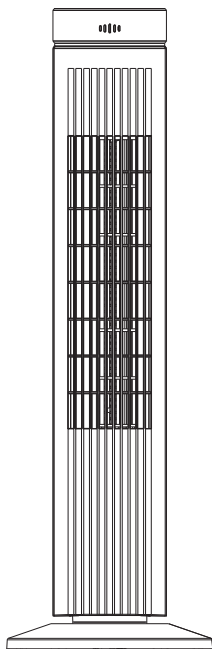

RTF-30CA

直立扇



僅供家庭使用

使用說明書

- 警告：使用本電器前，請仔細閱讀本說明書並妥善保存以供日後參考。
- 產品若有技術改進，將會編進新版說明書中，恕不另行通知。詳情請諮詢經銷商或製造商。
- 上圖僅供參考。請以實物為準。
- 該電器僅適用於隔熱良好的空間或場合使用。

目錄

重要安全說明	01
產品介紹	03
產品安裝	04
使用方法	05
常見故障問題	07
清潔和保養	08
產品規格	09
特別聲明	09
售後服務	09

重要安全说明

▲ 小心

1. 仔細閱讀安全操作規則和說明。
2. 本電器可供身體、感官或心智能力下降或缺乏經驗和知識的人（包括兒童）使用，前提是有負責其安全的人員提供監督或指導。
3. 監督兒童不要玩弄本電器。
4. 本電器可供8歲及以上的兒童以及身體、感官或心智能力較差或缺乏經驗和知識的人使用，前提是在監督或指導下以安全的方式使用，並瞭解所涉及的危險。
5. 兒童不得在無人監督的情況下進行清潔和保養。
6. 風扇運行時，切勿將手指、鉛筆或任何其他物體插入格柵。
7. 移動風扇位置時，須斷開電源。
8. 確保風扇在運行時處於穩定的表面上，以免翻倒。
9. 僅限室內使用。

警告

1. 如果電源線損壞，必須由製造商或其服務代理或具有類似資格的人員更換，以避免危險。
2. 為防止觸電，切勿將電器、電源線或插頭浸入水或其他液體中。
3. 不使用時及清潔前，應從插座上拔下電源插頭。
4. 風扇組裝完成後，不得再取下轉子葉片護罩。

產品介紹

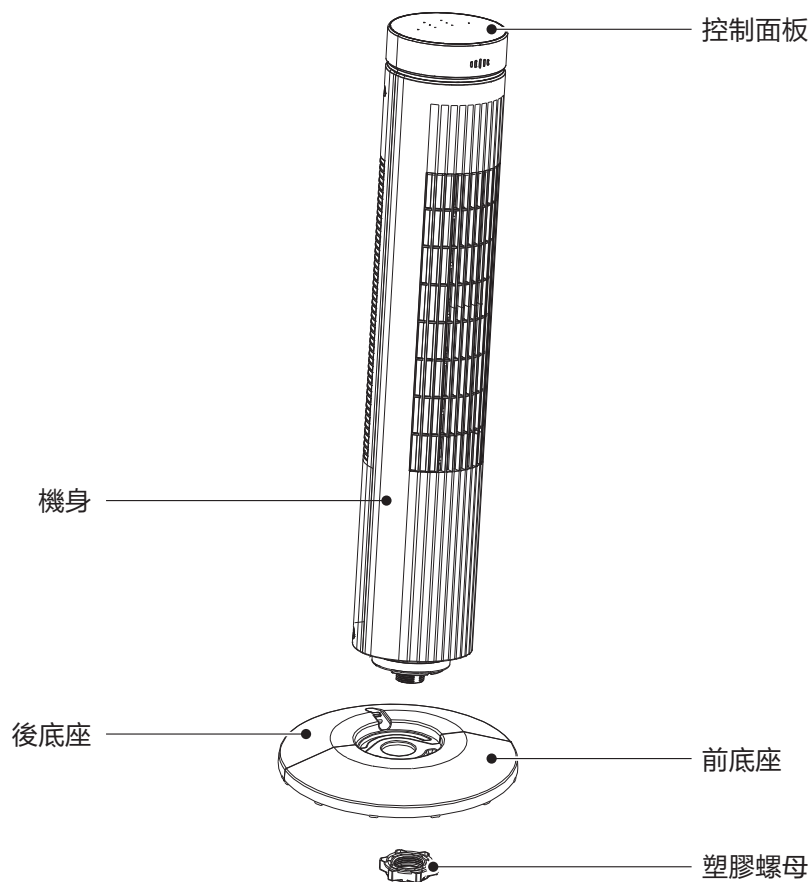

[注意]

本說明書中的所有圖片僅供說明之用。實物與插圖如有差異，以實物為準。
安裝前請從包裝內取出組件。

產品安裝

1. 從包裝箱中取出底座的兩個部分。將A部分的兩個杆插入B部分的兩個孔中，將B部分的兩個杆插入A部分的兩個孔中，組裝底座，如圖1所示。



圖1

2. 將電源線穿過插槽，然後將風扇機身插入底座。用塑膠螺母將風扇機身固定在底座上，如圖2所示。





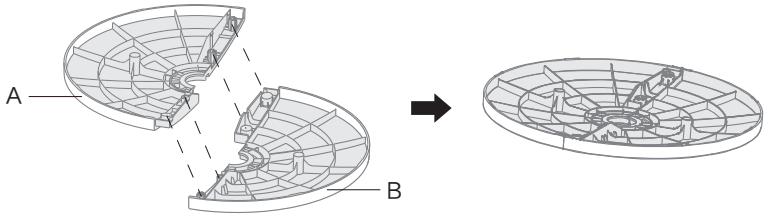

圖2

[注意]

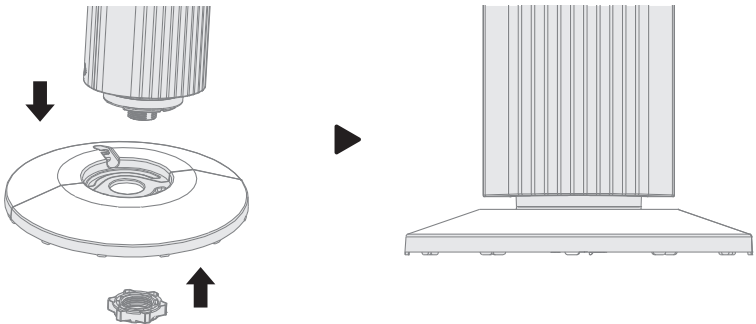
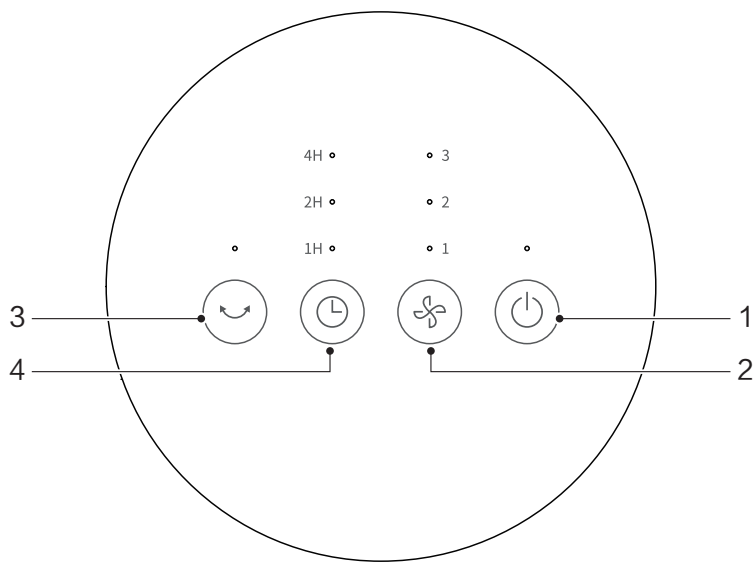
安裝底座時，請將機器放置在包裝泡沫或其他柔軟表面上，並將其倒置，以免造成刮痕。

使用方法



序號	按鈕	功能說明
1	 開/關	<ul style="list-style-type: none">• 接通電源後，機體會發出"BI"一聲。• 按下可啟動/關閉風扇
2	 速度	<ul style="list-style-type: none">• 在開機狀態下，按下可按以下風速等級順序迴圈：1-2-3-1。
3	 擺動	<ul style="list-style-type: none">• 在開機狀態下，按下可選擇擺動模式。
4	 定時	<ul style="list-style-type: none">• 按下可設置定時時間為1H/2H/3H/4H/5H/6H/7H，相對應的定時功能指示燈亮，顯示屏顯示相對應的定時數字。當所有指示燈熄滅時，為取消定時功能。

遙控器

- 遙控器上的按鈕（如擺動、開/關和定時器）與風扇上相應按鍵的功能相同。
- 減少和增加按鈕可用於速度和定時器功能。
- 遙控器在風扇前方16英尺範圍內和30°角範圍內有效操作。
- 電池含有重金屬、酸鹼物質，威脅人體健康；廢舊電池應分類回收。

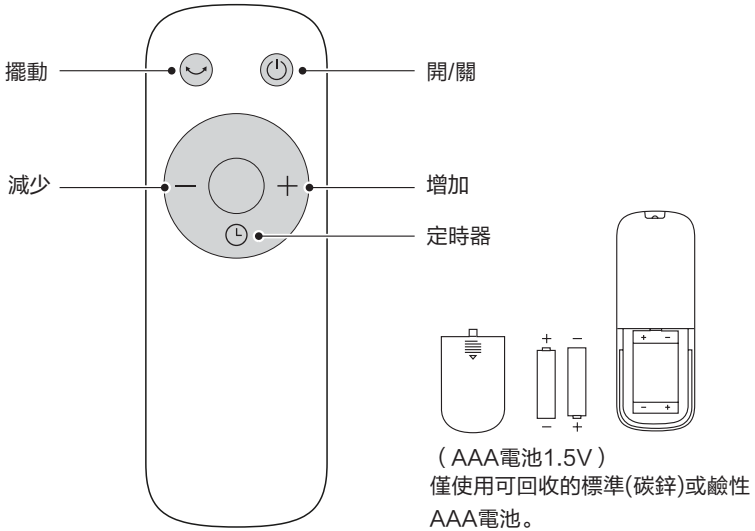

⚠ 警告

- 使用“AAA”型標準(碳鋅)或鹼性電池。切勿使用可充電電池。
- 切勿將新舊電池混用。
- 切勿混合使用鹼性、標準（碳鋅）或可充電（鎳鎘、鎳氫等）電池。

常見故障問題

電器的操作可能會導致錯誤和故障。下表包含可能的原因以及解決方法。建議仔細閱讀下表，以節省致電信興電器服務中心有限公司的時間和金錢。

故障	原因	解決方法
風扇安裝後無法正常工作	電源線未插入插座或接觸不良。	確保插頭正確插入插座。
	機身上的開關未打開。	打開機身上的開關。

清潔和保養

注意事項

風扇需要的保養很少。切勿嘗試自行修理。如需服務，請聯繫信興電器服務中心。

1. 清潔和組裝前，應拔下風扇電源。
2. 為確保馬達有足夠的空氣流通，應保持馬達附近的通風口無塵。清除灰塵時切勿拆卸風扇。
3. 使用浸有溫和清潔劑的軟布擦拭外部零件
4. 切勿使用任何研磨性清潔劑或溶劑，以免刮傷表面。
5. 切勿使用以下任何一種清潔劑：汽油、稀釋劑。
6. 切勿讓水或任何其他液體進入馬達外殼或內部零件。
7. 清潔前，務必拔下電源插頭。
8. 塑膠部件應使用浸有溫和肥皂的軟布清潔。用乾布徹底清除肥皂泡沫。

產品規格

型號	RTF-30CA
顏色	黑色
額定電壓	220-240V~
額定頻率	50Hz
額定功率	35W
尺寸(寬x深x高)	245 × 245 × 764毫米
淨重	2.9千克(約)

特別聲明

1. 本資料上所有內容經過認真核對，如有任何印刷及內容上的誤解，本公司將保留解釋權。
2. 本產品若有技術改進，會編進新版說明書中，恕不另行通知；產品外觀及顏色如有改動，則以實物為準。
3. 用戶如需要電子版使用說明書，請致電信興電工工程有限公司熱線查詢：2861 2767。

售後服務

由購買日期起之一年保修期內，經信興電器服務中心有限公司之服務人員證實乃在正常使用之情況下發生者，本公司將提供免費修理及更換零件。經更換之任何損壞零件，將歸屬本公司。保修範圍不包括修理或更換產品之附件、電源線及機殼等，如有需要服務時，用戶須另付費用。

用戶請於維修時出示購買收據 / 換購收據及保修證，如有任何疑問，請致電信興電器服務中心有限公司熱線查詢：2406 5666。

如在保修證內所列之電器：

- 1) 曾經被非本公司技術人員明顯地或非明顯地進行改裝、更改或修理
- 2) 曾經被錯誤或不適當或疏忽使用、或因液體浸蝕、水濺、不正常供電、天災、意外或外來因素造成損壞
- 3) 並非安裝在陸上固定地點
- 4) 不當安裝位置影響正常操作
- 5) 非工商業用型號產品，被用作工商業用途
- 6) 用戶搬遷地址或更換物主而未能及時通知信興電器服務中心有限公司者，保修證將自動失效。



RTF-30CA TOWER FAN

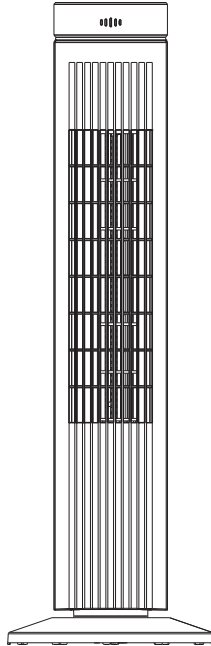

For Household Use Only

OPERATION MANUAL

- Warning notices: Before using this product, please read this manual carefully and keep it for future reference.
- The design and specifications are subject to change without prior notice for product improvement. Consult with your dealer or manufacturer for details.
- The diagram above is just for reference. Please take the appearance of the actual product as the standard.
- The device is only suitable for well insulated spaces or occasion use.

Contents

Important Safeguards	01
Product Overview	03
Product Installation	04
Operating Instructions	05
Troubleshooting	07
Cleaning And Maintenance	08
Specification	09
Special Avowal	09
After Sales Services	09

Important Safeguards

CAUTION

1. Read Rules for Safe Operation and Instructions Carefully.
2. This appliance is not to be used by persons (including children) with reduced physical, sensory or mental capabilities, or lack of experience and knowledge, unless they have been given supervision or instruction.
3. Children being supervised not to play with the appliance.
4. This appliance can be used by children aged from 8 years and above and persons with reduced physical, sensory or mental capabilities or lack of experience and knowledge if they have been given supervision or instruction concerning use of the appliance in a safe way and understand the hazards involved.
5. Cleaning and user maintenance shall not be made by children without supervision.
6. Never insert fingers, pencils, or any other object through the grille when fan is running.
7. Disconnect fan when moving from one location to another.
8. Be sure fan is on a stable surface when operating to avoid overturning.
9. Indoor use only.

WARNING

1. If the supply cord is damaged, it must be replaced by manufacturer or its service agent or a similarly qualified person in order to avoid a hazard.
2. To protect against the risk of electrical shock, do not immerse the unit, cord or plug in water or other liquid.
3. When the appliance is not in use and before cleaning, unplug the appliance from the outlet.
4. When the fan was assembled, the rotor blade guard shall not be taken off anymore.

Product Overview

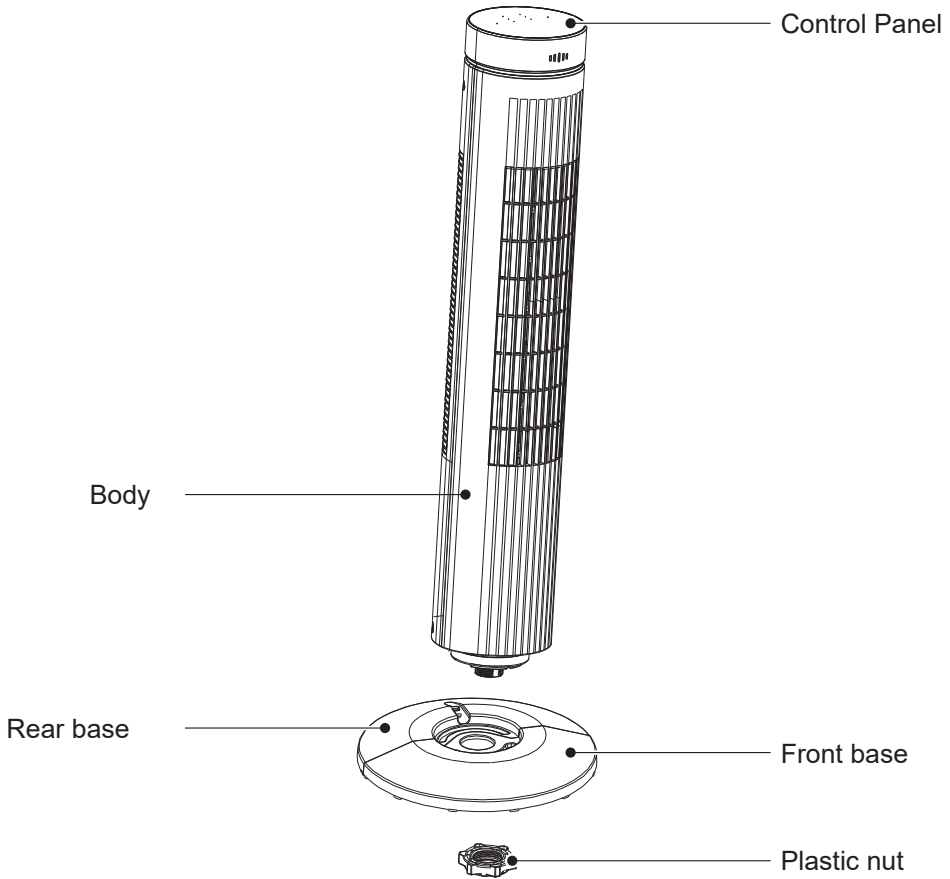

[Note]

All the pictures in this manual are for explanation purpose only. Any discrepancy between the real object and the illustration in the drawing shall be subject to the real subject.
Remove parts from the component before performing installation.
Please remove components from packaging before installation.

Product Installation

1. Take out the two parts of base from packing box. Insert the two poles of part A into two holes of part B, and insert the two poles of part B into two holes of part A to assemble the base as Fig 1.

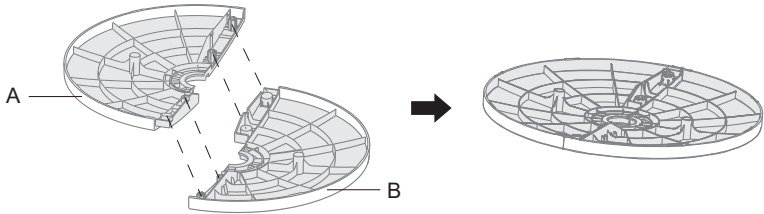

Fig 1

2. Pass the power cord through the slot, then insert the fan body into the base. Fix the fan body on the base with the plastic nut as Fig 2.

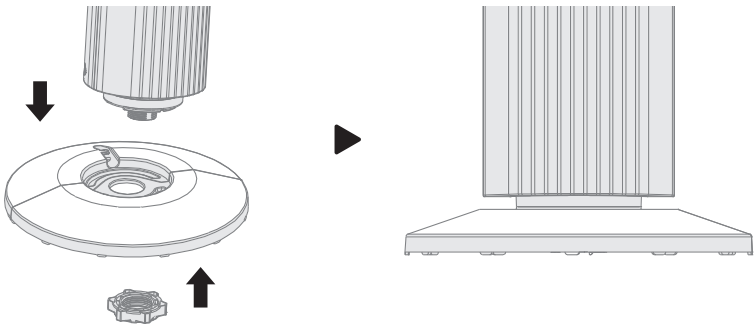
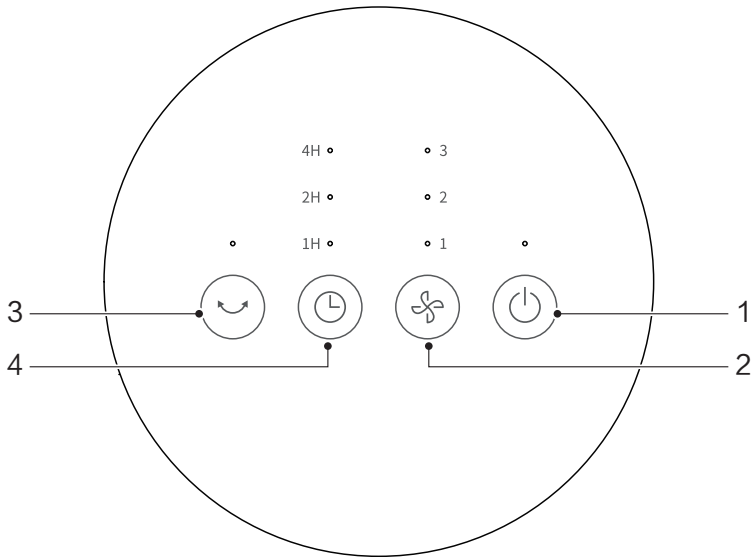





Fig 2

[Note]

Please place the machine on the packing foam or other soft surfaces and invert it to avoid scratching a mark when install the base.

Operating Instructions



No	Button	Function Description
1	 ON/OFF	<ul style="list-style-type: none"> • Insert the plug, the fan will have a 'BI" sound. • Press to switch on/switch off the fan.
2	 SPEED	<ul style="list-style-type: none"> • In power-on state, press to cycle in the following wind speed level sequence: 1-2-3-1.
3	 OSC	<ul style="list-style-type: none"> • In power-on state, press to select oscillation mode.
4	 TIMER	<ul style="list-style-type: none"> • Press to activate the timer 1H/2H/3H/4H/5H/6H/7H. The indicator light will light up accordingly, LED display show the timer setting. No timer setting if all the indicator lights are off.

Remote Control

- The buttons on the remote controller such as OSC, ON/OFF, and TIMER have identical functions to their corresponding keys on the unit.
- Decrease and Increase buttons can be used for SPEED and TIMER function.
- The remote control operates effectively within 16 feet in front of the product and within an angle of 30°.
- The battery contains heavy metals, acid and alkali substances, which threaten human health; waste batteries should be sorted and recycled.

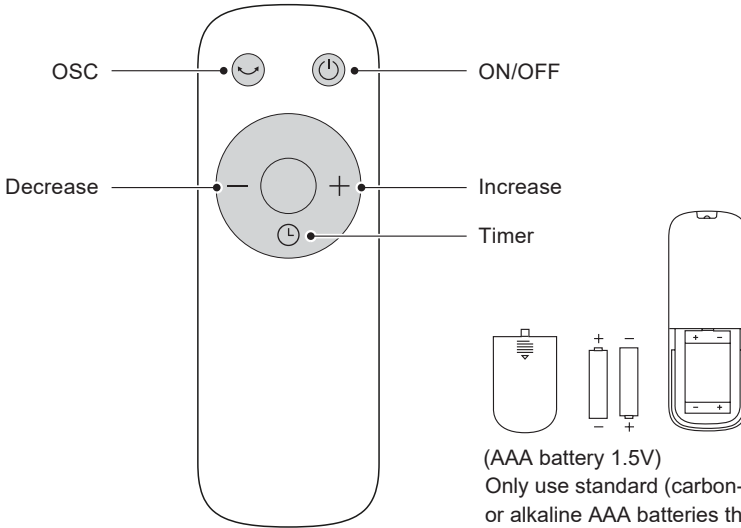

⚠ WARNING

- Use standard (carbon-zinc) or alkaline batteries of type “AAA”. DO NOT use rechargeable batteries.
- Do not mix new batteries with old.
- Do not mix alkaline, standard (carbon-zinc) or rechargeable (Ni-Cd, Ni-MH, etc.) batteries.

Troubleshooting

Operation of your appliance can lead to errors and malfunctions. The following tables contain possible causes and notes for resolving malfunction. It is recommended to read the table below carefully in order to save your time and money that may cost for calling to Shun Hing Electric Service Centre Ltd.

Fault Problem	Fault Cause	Fault Solution
The fan does not work properly after installed	The power cable is not plugged in or has poor contact.	Make sure the plug is properly inserted into the socket.
	The switch on the body is not turned on.	Turn on the switch on the body.

Cleaning And Maintenance

PRECAUTIONS

The fan requires minimal maintenance. Do not try to fix it by yourself. Please contact Shun Hing Electric Service Centre Ltd. if service is needed.

1. Before cleaning and assembling, unplug the fan power.
2. To ensure adequate air circulation to the motor, keep vents near the motor free of dust. Do not disassemble the fan to remove dust.
3. Please wipe the exterior parts with a soft cloth soaked in mild detergent
4. Do not use any abrasive detergent or solvents to avoid scratching the surface.
5. Do not use any of the following as a cleaner: gasoline, thinner.
6. Do not allow water or any other liquid entering into the motor housing or interior parts.
7. Be sure to unplug from the electrical supply source before cleaning.
8. Plastic parts should be cleaned with a soft cloth moisten with mild soap. Thoroughly remove soapsuds with dry cloth.

SPECIFICATION

Model	RTF-30CA
Color	BLACK
Rated voltage	220-240V~
Rated frequency	50Hz
Rated power	35W
Dimension (W x D x H)	245 x 245 x 764mm
Net weight	2.9kg (Approx.)

SPECIAL AVOWAL

1. The information above has been checked. Our company reserves the hermeneutic power to any printing errors or misunderstanding on the content.
2. If there are technical improvements on the appliance, the operation manual will be updated without any prior notice. The product appearance and color are subject to the actual appliance.
3. The e-copy of operation manual can be sent by e-mail on requested, please call Shun Hing Electric Works & Engineering Co. Ltd. hotline at 2861 2767.

AFTER SALES SERVICES

For any defect, in the judgment of technician from Shun Hing Electric Service Centre Limited, caused under normal use, we are responsible for repairing or replacing parts of the said electrical appliance free of charge within one year guarantee period commencing from the date of purchase. Any defective part which has been replaced shall become our property. Guarantee service does not cover the repair or replacement of accessories, power cord or cabinet, etc. Additional charges shall be levied if services are required. Please present the official invoice and the guarantee certificate with the sales point's chop or the redemption center's chop for free maintenance. For enquiries, please call Shun Hing Electric Service Centre Limited hotline at 2406 5666.

Free guarantee service will not be provided to the appliance if: 1) it has been explicitly or implicitly modified, tampered with, altered or repaired in any way by persons other than technicians of the Company. Or 2) it has been damaged through misuse, negligence, liquid ingress or corrosion, power interruption, natural calamities or accident or external factors. Or 3) it is not a fixed installation on land. Or 4) the normal operation of the appliance is affected by improper installation. Or 5) the domestic model of appliance is used for industrial or commercial purpose. Or 6) the change of location or ownership of the product and did not inform Shun Hing Electric Service Centre Limited.

信興電工工程有限公司

SHUN HING ELECTRIC WORKS & ENGINEERING CO., LTD

辦公室: 香港九龍尖沙咀東部麼地道 67 號半島中心 9 樓

OFFICE: 9/F, PENINSULA CENTRE, 67 MODY ROAD, TSIMSHATSUI EAST, KOWLOON, HONG KONG

電話 TEL: (852) 2861 2767 傳真 FAX: (852) 2865 6706

網址 WEBSITE: www.rasonic.hk 電郵 EMAIL: shew@shunhinggroup.com

保養及維修 MAINTENANCE AND REPAIR SERVICE

信興電器服務中心有限公司

SHUN HING ELECTRIC SERVICE CENTRE LTD.

辦公室: 香港新界葵涌勝耀街 2 號信興中心 11 樓

OFFICE: 11TH FLOOR, SHUN HING CENTRE, 2 SHING YIU STREET, KWAI CHUNG, NEW TERRITORIES, HONG KONG

電話 TEL: (852) 2406 5666

傳真 FAX: (852) 2408 0316

網址 WEBSITE: www.shesc.com

消耗品/附件銷售熱線 CONSUMABLES/ ACCESSORIES SALES HOTLINE

電話 TEL: (852) 2406 5666

客戶服務中心 CUSTOMER SERVICE CENTRES

香港新界葵涌勝耀街 2 號信興中心 1 樓

1ST FLOOR, SHUN HING CENTRE, 2 SHING YIU STREET, KWAI CHUNG, NEW TERRITORIES, HONG KONG

電話 TEL: (852) 2406 5439

傳真 FAX: (852) 2408 1389

澳門慕拉士大馬路 193-199 號南嶺工業大廈 5 樓 I 座

AVENIDA DE VENCESLAU DE MORAIS, NO. 193-199, 5 ANDAR-I, EDF. INDUSTRIAL NAM LENG, MACAU

電話 TEL: (853) 2836 2928

傳真 FAX: (853) 2833 6405

有關最新之客戶服務中心資訊, 請參閱信興服務中心網址 www.shesc.com 或致電維修服務熱線查詢。

For the latest information of customer service centres, please visit www.shesc.com or call us at our hotline.